

Specification Status: RELEASED

Max Electrical Rating at 20°C

Operating Voltage: 250V_{DC}
Interrupt Current: 3A_{RMS}

Fault Voltage: 600V_{RMS}

Lead Material: 22 AWG Sn plated copper
(0.65 mm [0.026"] nominal diameter)

Marking:

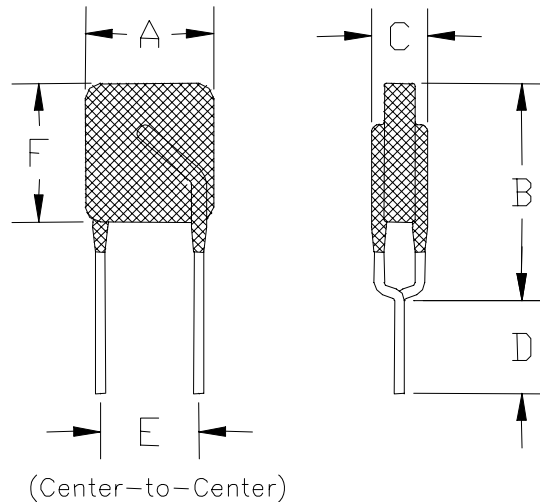
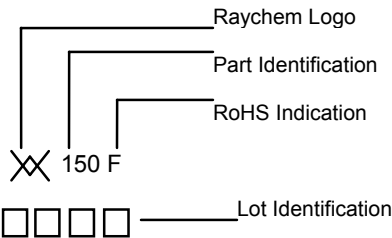

TABLE I. DIMENSIONS

	A		B		C		D		E	F	
	Min	Max	Min	Max	Min	Max	Min	Max	Nom	Min	Max
mm:	--	9.0	--	12.5	--	4.6	4.7	--	5.0	--	9.0
in:	--	(0.354)	--	(0.492)	--	(0.180)	(0.185)	--	(0.197)	--	(0.354)

TABLE II. PERFORMANCE RATINGS @ 20°C (unless otherwise noted):

I _{HOLD} (A)**	I _{TRIP} (A)	RESISTANCE (Ω)			TIME TO TRIP (s) @ 1A		OPERATING TEMPERATURE (°C)	
		R MIN	R MAX	R _{1MAX} *	TYP	MAX	MIN	MAX
0.130	0.300	9.0	12.0	22.0	1.0	3.0	-40	85

* Maximum device resistance at 20°C measured 1 hour post trip.

**Dependant on heat sinking.

Designed to assist equipment meet UL60950

Agency Recognitions: UL, CSA, TUV
Reference Documents: PS300
Precedence: This specification takes precedence over documents referenced herein.
Effectivity: Reference documents shall be the issue in effect on the date of invitation for bid.
CAUTION: Operation beyond the rated voltage or current may result in rupture, electrical arcing or flame.

ROHS Compliant

ELV Compliant

Pb-Free

Directive 2002/95/EC
Compliant

Directive 2000/53/EC
Compliant

